

# ALTAIR 120 H, 160 H

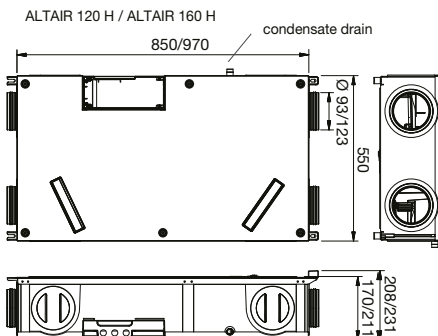

A



■ construction

## Technical parameters

### Cabinet

is made of durable, high-density EPP. The front metal panel is powder coated white. Connecting circular spigots with double-edged seal Ø 93 mm ALTAIR 120 H, Ø 123 mm ALTAIR 160 H. The spigots can be turned sideways. Revision access is from the front of the unit.

### Fans

The unit contains two radial fans with forward-curved blades with an EC motor.

### Engines

are single-phase EC with low consumption, 230V/50Hz. Protection IP21.

### Recuperation

Counter-current heat exchanger with an efficiency of up to 88 % (ALTAIR 120 H) nebo 87 % (ALTAIR 160 H). The exchanger is accessible after opening the front panel.

### Filters

Two plate filters of class G4 (ISO coarse 65%) are installed in the unit for suction and exhaust.

### Replacement filters:

- AFR-ALTAIR 120 filter set G4/G4
- AFR-ALTAIR 120 filter set M5/G4
- AFR-ALTAIR 160 filter set G4/G4
- AFR-ALTAIR 160 filter set M5/G4

### Electrical connection

A three-wire 230V/50Hz power cable is issued from the unit, which is not terminated by a plug (connection to the box).

### Regulation

The unit is equipped with a fully automatic control system with flow regulation according to relative humidity.

The innovative control system with temperature sensors and humidity sensor ensures fully automatic operation of continuous ventilation without the need for any further intervention in the control of the unit. A wired controller is included, which allows switching from automatic to manual operation with the possibility of switching between three power speeds. The system indicates filter contamination by an acoustic signal or LED indication on the connected controller. The unit is equipped with a contact to activate the BOOST function.

### Construction

The unit is intended for horizontal installation under the ceiling in interior spaces. The required ambient temperature is in the range of 10 to 50 °C. The unit must be mounted in such a way that there is enough space to remove the front of the unit, change the filters, connect the condensate drain to the waste with a siphon odor trap SF-P 138 and to carry out periodic revisions of the electrical installation. In the case of mounting the unit above the suspended ceiling, an inspection opening for the operator is required.

### Noise

The sound power level at the casing is given in the table of technical parameters.

### Instructions

The unit is „plug & play“, which means really easy to get up and running without complicated setup after installation.

If it is necessary to add preheating or reheating to the unit, MBE(-AFP) or MBW pipe heaters can be used. Filter changes are recommended at least once a year. The design of a controlled ventilation system

with heat recovery and its use in buildings with category B gas appliances (gas boilers and open chamber water heaters) or open fire appliances burning solid or liquid fuels with flue gas extraction to the chimney is governed by the applicable regulations. Ventilation shall comply with the normative regulations for fire safety in buildings and shall not be in contravention of the fire regulations.

### Information

A comprehensive ventilation system with a small unit designed for the ventilation of apartments, apartment buildings and family houses. The unit is designed for continuous operation.



EC engine



Plug &amp; play

maximum efficiency  
recuperationenergy efficient  
ventilation system

Type	flow rate (100 Pa) [m³/h]	tension [V]	max. input [W]	acoustic level power* [dB(A)]	efficiency [%]	mass [kg]
ALTAIR 120 H	120	230	53	47	88	20
ALTAIR 160 H	160	230	74	48	87	25

\* acoustic power level at reference flow (70 % max. flow) and external static pressure 50 Pa

## ALTAIR 120 H, 160 H

## Characteristics

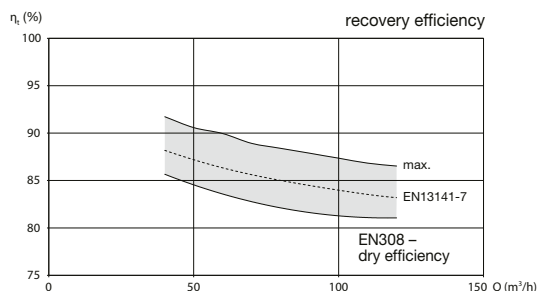
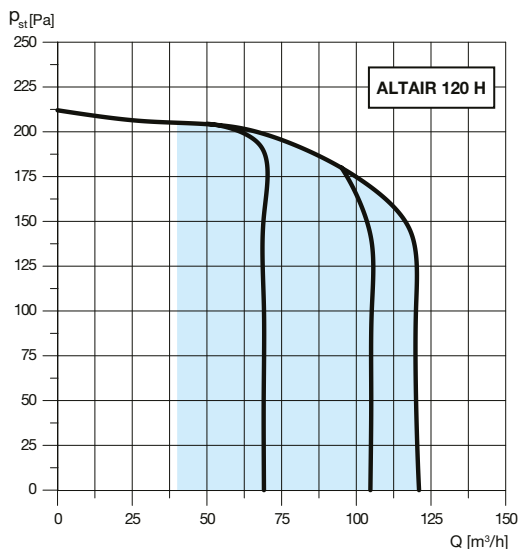

Power consumption of the unit according to work. power characteristic point –  $P_{abs}$  [W]

$p_{st}$ [Pa]	$Q$ [ $m^3/h$ ]		
	70	105	120
150	40	49	53
100	31	37	47
50	12	17	23

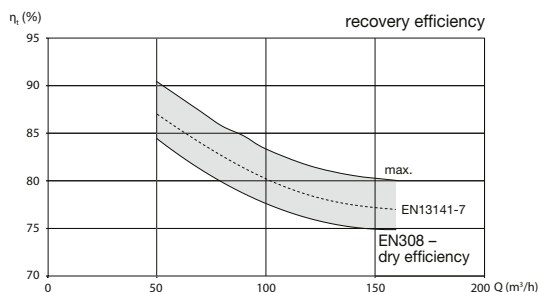
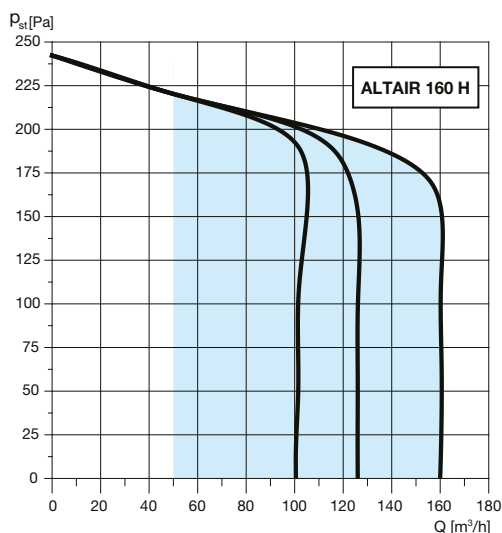

Power consumption of the unit according to work. power characteristic point –  $P_{abs}$  [W]

$p_{st}$ [Pa]	$Q$ [ $m^3/h$ ]		
	100	125	150
150	50	55	74
100	35	44	54
50	26	35	51

## Performance characteristics

$P_{st}$  static pressure in Pa

$Q$  flow rate  $v$   $m^3/h$

clean filters

the unit's possible operating point area

For information on the acoustic performance on the throats and the shell at the required working point, please contact our technical support.

## Supplementary image

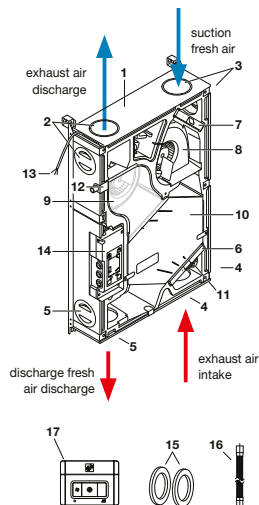
**Package contents of the ALTAIR 120 H**

1. recovery unit ALTAIR
2. exhaust air pressure (EHA)
3. fresh air intake (ODA)
4. exhaust air intake (ETA)
5. fresh air discharge into the room (SUP)
6. filter G4 (ISO coarse 65%) on the output
7. filter G4 (ISO coarse 65%) for suction
8. fan for suction
9. fan on the output
10. recovery exchanger
11. humidity sensor
12. condensate drain
13. power cable
14. terminal block
15. EPDM gasket
16. condensate drain hose (150 mm)
17. unit controller (including 10 m cable)



unit controller (supplied)



SPCM MODUL LITE  
communication module for the possibility  
of controlling the  
unit via the mobile app  
or the web interface



AxB crossbox  
attachment for changing the position  
of throats



throat reversal options



SONOULTRA  
flexible silencers



SF-P 138  
vacuum siphon with cap



# Connectair®

www.connectairapp.com

## Connectair®

Remote management designed specifically for Soler & Palau devices. Control your ventilation system remotely.

### Features

- easy and intuitive operation
- clear visualization
- home air quality monitoring
- air flow control
- safe location in the Cloud (secure internet storage)
- filter status check
- operation history and more

### Remote maintenance

Remote access to the unit, with the possibility to perform regular maintenance necessary for optimal and trouble-free operation. The company in charge of installation and management can, subject to approval, maintain multiple air handling units.



ALTAIR 120 V a modul SPCM  
Connectair – remote unit management

