

# **MVF-S Varioflow® – variable flow controller**

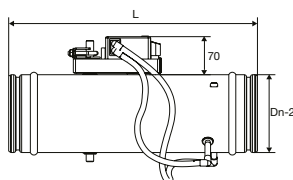

MVF-S

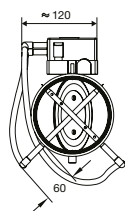
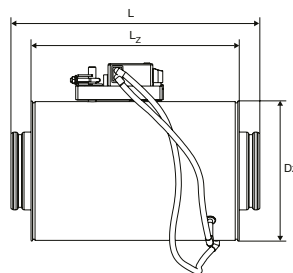
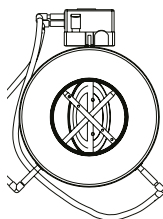

MVF-S-I

## **Technical parameters**

The MVF-S control valve for circular piping with built-in control consists of a tight valve, actuator and measuring device. The input data is compared with a reference signal and then the damper setting is adjusted by the actuator.

- for controlling supply and exhaust air in ventilation systems
- can be controlled by temperature, air quality, pressure, etc. sensors
- damper with rubber seal
- maximum air velocity 12 m/s
- MVF-S-I – version with external insulation, thickness. 50 mm
- standard design analogue input 0–10 V, actuator reconfiguration via Belimo Assistant mobile app using NFC communication

Type	Ø Dn [mm]	L [mm]	Ø Dz [mm]	Lz [mm]	Q min [m³/h]	Q max [m³/h]
MVF-S 100	100	400	198	330	57	283
MVF-S 125	125	400	223	330	88	442
MVF-S 160	160	400	258	330	145	723
MVF-S 200	200	400	298	330	226	1130
MVF-S 250	250	500	348	430	353	1766
MVF-S 315	315	600	413	530	561	2804
MVF-S 400	400	600	498	530	904	4522
MVF-S 500	500	750	598	680	1413	7065
MVF-S 630	630	850	728	780	2243	11216

For sizes 100 to 400, the Belimo LMV-D3-MP servo drive (5 Nm) is used, for sizes 500 and 630 the Belimo NMV-D3-MP servo drive (10 Nm) is used.

## **Additional illustration**

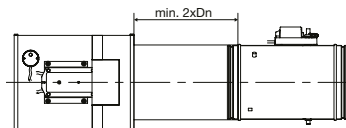
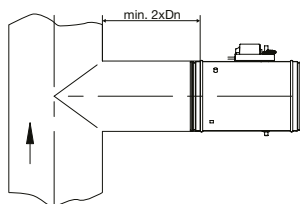
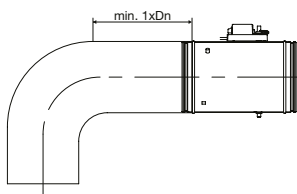

recommended installation



### **VARIOSU 24-10 power supply**

allows the connection and power supply of air flow controllers (MVF-S and IVF-S) with AC 24 V supply voltage, which are used in DCV central ventilation systems. Air quality sensors with AC 230 V supply voltage and room controllers with AC 24 V supply voltage can be connected to the power supply. The power supply is supplied in a special sheet metal enclosure with a removable lid. In addition, the power supply is equipped with two additional AC 24 V and DC 10 V power outputs, which are not primarily intended

to power the flow controllers and drivers, but allow the connection of other optional sensors or instruments.

### **Notice**

When designing, the total power consumption of all devices connected to the VARIOSU 24-10 power supply must be taken into account. The VARIOSU 24-10 wiring diagram for specific applications must be requested from the technical department of ELEKTRODESIGN Fans, Ltd.

Details [www.elektrodesign.cz](http://www.elektrodesign.cz)